

THRUST BALL BEARINGS

Thrust ball bearings and thrust angular contact ball bearings are separate bearing types. they are formed by cage with steel ball,shaft washer and housing washer,thus they can easily be **mounted and dismounted** separately **on shaft and bearing housing**.

Thrust ball bearings can be **classified** into one-way thrust ball bearing(51000 type) and double-way thrust ball bearing(52000 type) according to the different structures.it can also be **classified** into **flat-back face** thrust ball bearings and thrust ball bearings with **aligning seat washer** according to the difference of **flat back face**.thrust ball bearing with **aligning seat washe** has the performance of self-aligning and can reduce the **effect** of installation error. One-way thrust ball bearing can bear single-directional axial load and limit the one-way axial displacement;while double-way thrust ball bearing can bear bi-directional axial load and limit the two-way axial displacement .

In general, **the thrust ball bearing use pressed steel plate cage,when the outer diameter $D \geq 250\text{mm}$ use machined solid cage.**

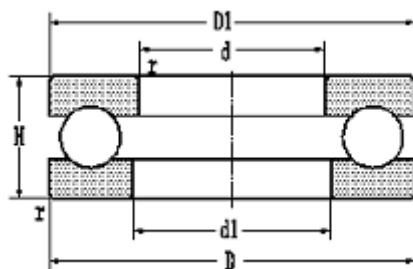

Single-direction thrust ball bearing

Designation		Dimension			(kN) Rating load		Weight
NEW	OLD	d	D	H	dyn	sta	kg
51140	8140	200	250	37	168	655	4.25
51240	8240	200	280	62	338	1220	12
51340	8340	200	340	110	624	2400	44.5
51144	8144	220	270	37	178	735	4.6
51244	8244	220	300	63	351	1320	13
51148	8148	240	300	45	234	965	7.55
51248	8248	240	340	78	462	1860	23
51348	8348	240	380	112	692	2870	51
51152	8152	260	320	45	238	1020	8.1
51252	8252	260	360	79	475	2000	25
51156	8156	280	350	53	319	1340	12
51256	8256	280	380	80	494	2160	26.5
51160	8160	300	380	62	364	1600	17.5
51260	8260	300	420	95	605	2750	42
51164	8164	320	400	63	371	1700	19
51264	8264	320	440	95	572	2700	45.5
51168	8168	340	420	64	377	1800	20.5
51268	8268	340	460	96	605	2900	48.5
51368	8368	340	540	160	1120	5720	145
51172	8172	360	440	65	390	1900	22
51272	8272	360	500	110	741	3800	70
51176	8176	380	460	65	397	2000	23
51276	8276	380	520	112	728	3800	73
51180	8180	400	480	65	403	2120	24
51280	8280	400	540	112	802	4310	76
51184	8184	420	500	65	410	2200	25.5

LUOYANG JINYUAN OUTSIZE BEARING CO.,LTD

51188	8188	440	540	80	527	3000	42
51288	8288	440	600	130	808	4430	112
51192	8192	460	560	80	527	3000	43.5
51292	8292	460	620	130	892	5230	119
51196	8196	480	580	80	540	3250	45.5
511/500	81/500	500	600	80	553	3350	47
512/500	82/500	500	670	135	1020	6200	140
510/500	10089/500	500	540	30	101	835	6.66
593/500	90083/500	500	750	150	950	6320	228
511/530	81/530	530	640	85	663	4250	58.5
590/560	90089/560	560	610	30	128	960	9.55
591/600	90081/600	600	710	67	630	4275	50.1
512/630	82/630	630	850	175	1320	9300	252
511/670	81/670	670	800	105	852	6100	105
510/670	10089/670	670	730	45	284	2160	20.5
572/710	70082/710	710	950	109	787	980	199.4
592/710	90082/710	710	950	145	1025	1296	284
591/750 V	97081/750	750	900	90	810	6210	100
517/780	87/780	780	930	100	800	6069	129
591/1060 V	97081/1060	1060	1250	115	940	1240	215
510/1180	10089/1180	1180	1280	80	738	7680	108

<http://www.lybearing.com> tel:0086-0379-67279705 fax:0086-0379-64276136